

## Overview of 2017 Admission Process for Privately-Funded International Students

International students are exempted from the National Center Test for University Admissions. The result of the Examination for Japanese University Admission for International Students (EJU) administered by Japan Student Services Organization (for those who are applying for the School of Science and Technology, a score on one of the following tests taken in or after January 2015 is also required: TOEFL-PBT, TOEFL-iBT, TOEFL-ITP (administered by Gunma University), TOEIC public test, TOEIC-IP (administered by Gunma University) or IELTS) as well as an academic achievement test individually administered by each department and academic transcripts are comprehensively evaluated.

**Note : Education is offered in the same manner to international students and students enrolled through special or general admission process**

# Gunma University Timeline of Admission Process

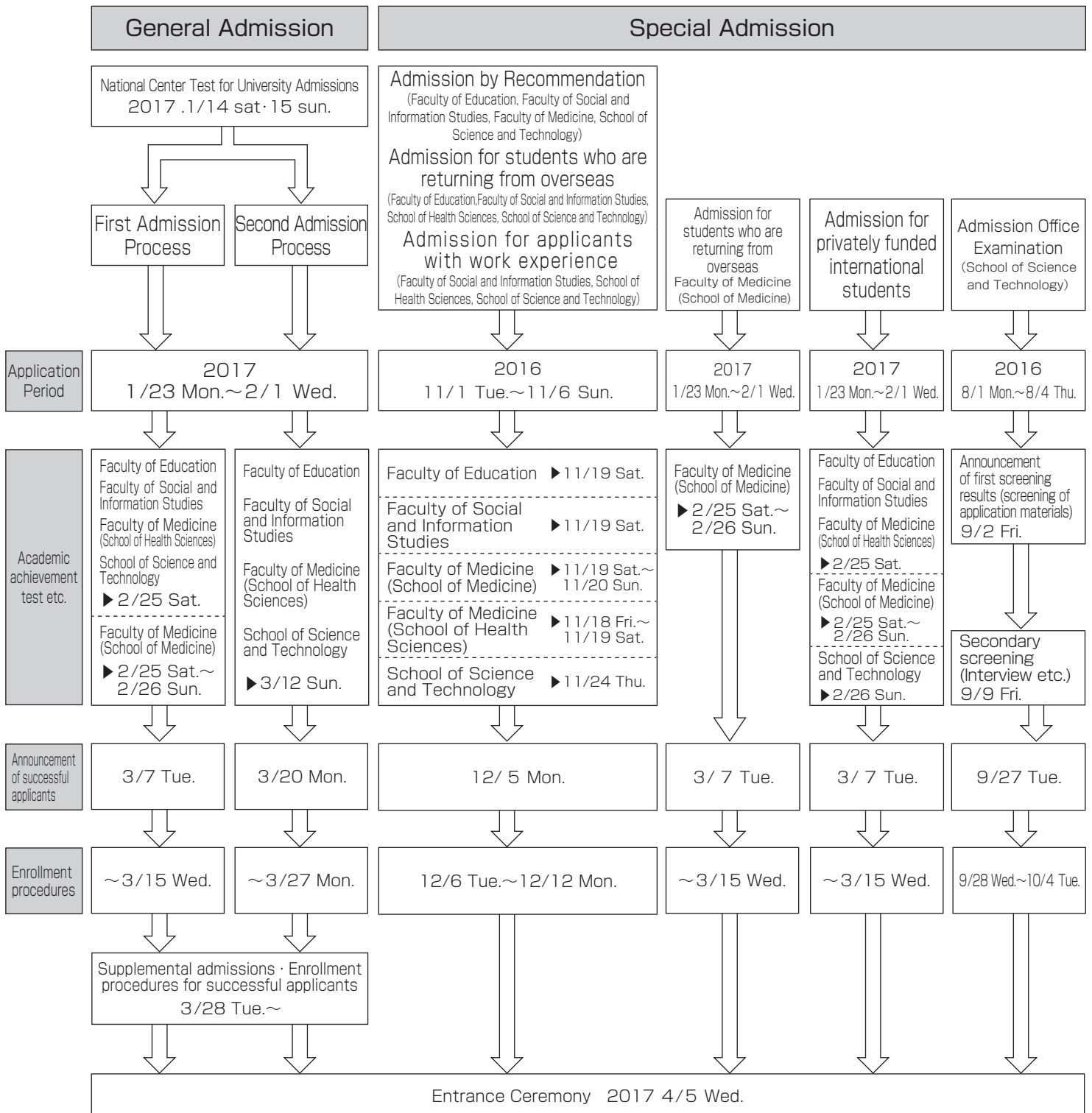

In addition to above admission processes, our university admits transfer students (except for Faculty of Education).

## Admission for Privately-Funded International Student

Applicable department/school	Faculty of Education	Faculty of Social and Information Studies	Faculty of Medicine		School of Science and Technology																																																																							
			School of Medicine	School of Health Sciences	Department of Chemistry and Chemical Biology Department of Mechanical Science and Technology Department of Environmental Engineering Science Department of Electronics and Informatics																																																																							
Number of students accepted	A few for each major	A few	A few	A few for each major	A few for each School																																																																							
Qualifications	<p>Applicants who meet the following criteria may apply</p> <ol style="list-style-type: none"> <li>Applicant who is not Japanese citizen, and holds or is expected to have resident status that does not prevent from entering into university under provisions in the Immigration Control and Refugee Recognition Act, except for those who are allowed permanent residency in Japan (Note 1).</li> <li>Applicant who meets one of the following               <ol style="list-style-type: none"> <li>Applicant who has completed or plans to complete all the requirements of a 12 school year education system in foreign country by March 31, 2017 or has equivalent requirements as certified by Ministry of Education, Culture, Sports, Science and Technology</li> <li>Applicant who reaches at least 18 years of age by March 31, 2017 and has obtained one of the following qualifications : International Baccalaureate (awarded by the International Baccalaureate Organization), Abitur (designated by the Federal Republic of Germany), Baccalaureate (designated by the French Republic), or General Certificate of Education Advanced Level (awarded by the United Kingdom of Great Britain and Northern Ireland)</li> <li>Applicant who has completed or plan to complete the standard 12 school year curriculum at educational institutions certified by international accreditation bodies (WASC, ACSI, CIS) selected by the Minister of Education, Culture, Sports, Science and Technology. The applicant must be 18 or older by March 31, 2017.</li> <li>Applicant who has taken the high school equivalence test individually administered by our university, and is determined to possess academic background equivalent or superior to high school graduate. The applicant must be at least 18 years old by March 31, 2017 (Note 2).</li> </ol> </li> <li>Applicant who has taken the 2016 Examination for Japanese University Admission for International Students administered by Japan Student Services Organization (either 1st session or 2nd session) as follows (Note 3). For the applicant who is applying for the School of Science and Technology, a score on one of the following tests taken in or after January 2015 is also required: TOEFL-PBT, TOEFL-iBT, TOEFL-ITP (conducted by Gunma University), TOEIC public test, TOEIC-IP (conducted by Gunma University) or IELTS</li> </ol>																																																																											
			<table border="1"> <thead> <tr> <th colspan="2">Faculty/School/Major</th> <th>Japanese as a Foreign Language</th> <th>Mathematics</th> <th>Japan and the World</th> <th colspan="3">Science</th> <th>Language used</th> </tr> <tr> <th colspan="2"></th> <th></th> <th></th> <th></th> <th>Physics</th> <th>Chemistry</th> <th>Biology</th> <th></th> </tr> </thead> <tbody> <tr> <td rowspan="2">Faculty of Education</td> <td>Japanese, Social Studies, English, Music, Art, Home Economics, Health and Physical Education, Education, Educational Psychology, Special Education</td> <td>○</td> <td>Course 1</td> <td>○</td> <td>-</td> <td>-</td> <td>-</td> <td>Japanese</td> </tr> <tr> <td>Mathematics, Science, Technical Education</td> <td>○</td> <td>Course 2</td> <td>-</td> <td colspan="3">Select two subjects</td> <td>Japanese</td> </tr> <tr> <td colspan="2">Faculty of Social and Information Studies</td> <td>○</td> <td>Course 1 or Course 2</td> <td>-</td> <td colspan="3">Select Japan and the World or Science. If Science is selected, choose two of the three Science subjects</td> <td>Japanese</td> </tr> <tr> <td rowspan="2">Faculty of Medicine</td> <td>School of Medicine</td> <td>○</td> <td>Course 2</td> <td>-</td> <td colspan="3">Select two subjects</td> <td>English</td> </tr> <tr> <td>School of Health Sciences</td> <td>○</td> <td>Course 2</td> <td>-</td> <td colspan="3">Select two subjects</td> <td>Japanese</td> </tr> <tr> <td>School of Science and Technology</td> <td>Department of Chemistry and Chemical Biology Department of Mechanical Science and Technology Department of Environmental Engineering Science Department of Electronics and Informatics</td> <td>○</td> <td>Course 2</td> <td>-</td> <td>○</td> <td>○</td> <td>-</td> <td>Japanese</td> </tr> </tbody> </table>				Faculty/School/Major		Japanese as a Foreign Language	Mathematics	Japan and the World	Science			Language used						Physics	Chemistry	Biology		Faculty of Education	Japanese, Social Studies, English, Music, Art, Home Economics, Health and Physical Education, Education, Educational Psychology, Special Education	○	Course 1	○	-	-	-	Japanese	Mathematics, Science, Technical Education	○	Course 2	-	Select two subjects			Japanese	Faculty of Social and Information Studies		○	Course 1 or Course 2	-	Select Japan and the World or Science. If Science is selected, choose two of the three Science subjects			Japanese	Faculty of Medicine	School of Medicine	○	Course 2	-	Select two subjects			English	School of Health Sciences	○	Course 2	-	Select two subjects			Japanese	School of Science and Technology	Department of Chemistry and Chemical Biology Department of Mechanical Science and Technology Department of Environmental Engineering Science Department of Electronics and Informatics	○	Course 2	-	○	○	-	Japanese
	Faculty/School/Major		Japanese as a Foreign Language	Mathematics	Japan and the World	Science			Language used																																																																			
						Physics	Chemistry	Biology																																																																				
	Faculty of Education	Japanese, Social Studies, English, Music, Art, Home Economics, Health and Physical Education, Education, Educational Psychology, Special Education	○	Course 1	○	-	-	-	Japanese																																																																			
		Mathematics, Science, Technical Education	○	Course 2	-	Select two subjects			Japanese																																																																			
	Faculty of Social and Information Studies		○	Course 1 or Course 2	-	Select Japan and the World or Science. If Science is selected, choose two of the three Science subjects			Japanese																																																																			
	Faculty of Medicine	School of Medicine	○	Course 2	-	Select two subjects			English																																																																			
		School of Health Sciences	○	Course 2	-	Select two subjects			Japanese																																																																			
	School of Science and Technology	Department of Chemistry and Chemical Biology Department of Mechanical Science and Technology Department of Environmental Engineering Science Department of Electronics and Informatics	○	Course 2	-	○	○	-	Japanese																																																																			
<p><b>【Note】</b></p> <p>(Note 1) Even if applicants do not have Japanese citizenship, those who graduated from a Japanese high school or equivalent (including a special educational institution overseas certified by the Ministry of Education, Culture, Sports) are treated in the same manner as applicants who are applying through general admission. Therefore, this application process is not applicable.</p> <p>(Note 2) Those who wish to have their eligibility reviewed by the Individual Admission Review Process must contact below, apply for such process, and be certified by Thursday January 12, 2017.</p> <p>Contact information: Admissions Office Department of Academic Affairs at Gunma University Phone: 81-27-220-7150 Address: 4-2 Aramaki-machi Maebashi Gunma Japan 371-8510</p> <p>(Note 3) If applicants have taken both 1st and 2nd sessions of the 2016 Examination for Japanese University Admission for International Students, applicants must specify scores from which sessions.</p>																																																																												

Screening Method	International students are exempted from taking the National Center Test for University Admissions. Below ①~③ are comprehensively evaluated to determine the successful applicants. ① Score from the 2016 Examination for Japanese University Admission for International Students administered by Japan Student Services Organization. For those who applying for the School of Science and Technology, a score on one of the following tests taken in or after January 2015 is also required: TOEFL-PBT, TOEFL-iBT, TOEFL-ITP (conducted by Gunma University), TOEIC public test, TOEIC-IP (conducted by Gunma University) or IELTS ② Academic achievement test etc. individually administered by each department (see the following table)																					
	<table border="1"> <thead> <tr> <th colspan="2">Faculty/School/</th> <th>Individual academic achievement test etc.</th> </tr> </thead> <tbody> <tr> <td colspan="2">Faculty of Education</td> <td>Examination similar to general admission (First Admission Process)</td> </tr> <tr> <td colspan="2">Faculty of Social and Information Studies</td> <td>Mathematics, English and interview</td> </tr> <tr> <td rowspan="2">Faculty of Medicine</td> <td>School of Medicine</td> <td>Examination similar to general admission (First Admission Process)</td> </tr> <tr> <td>School of Health Sciences</td> <td>Examination similar to general admission (First Admission Process) and interview</td> </tr> <tr> <td rowspan="4">School of Science and Technology</td> <td>Department of Chemistry and Chemical Biology</td> <td rowspan="4">Interview</td> </tr> <tr> <td>Department of Mechanical Science and Technology</td> </tr> <tr> <td>Department of Environmental Engineering Science</td> </tr> <tr> <td>Department of Electronics and Informatics</td> </tr> </tbody> </table>		Faculty/School/		Individual academic achievement test etc.	Faculty of Education		Examination similar to general admission (First Admission Process)	Faculty of Social and Information Studies		Mathematics, English and interview	Faculty of Medicine	School of Medicine	Examination similar to general admission (First Admission Process)	School of Health Sciences	Examination similar to general admission (First Admission Process) and interview	School of Science and Technology	Department of Chemistry and Chemical Biology	Interview	Department of Mechanical Science and Technology	Department of Environmental Engineering Science	Department of Electronics and Informatics
	Faculty/School/		Individual academic achievement test etc.																			
	Faculty of Education		Examination similar to general admission (First Admission Process)																			
	Faculty of Social and Information Studies		Mathematics, English and interview																			
Faculty of Medicine	School of Medicine	Examination similar to general admission (First Admission Process)																				
	School of Health Sciences	Examination similar to general admission (First Admission Process) and interview																				
School of Science and Technology	Department of Chemistry and Chemical Biology	Interview																				
	Department of Mechanical Science and Technology																					
	Department of Environmental Engineering Science																					
	Department of Electronics and Informatics																					
③ Academic transcripts																						
Application Period	Monday January 23, 2017 through Wednesday February 1, 2017																					
Screening date	Screening dates for each Faculty/School are as follows:																					
	<table border="1"> <thead> <tr> <th colspan="2">Faculty/School/</th> <th>Screening date</th> </tr> </thead> <tbody> <tr> <td colspan="2">Faculty of Education</td> <td>2017 2/25 Sat.</td> </tr> <tr> <td colspan="2">Faculty of Social and Information Studies</td> <td>2017 2/25 Sat.</td> </tr> <tr> <td rowspan="2">Faculty of Medicine</td> <td>School of Medicine</td> <td>2017 2/25 Sat. , 2/26 Sun.</td> </tr> <tr> <td>School of Health Sciences</td> <td>2017 2/25 Sat.</td> </tr> <tr> <td rowspan="4">School of Science and Technology</td> <td>Department of Chemistry and Chemical Biology</td> <td rowspan="4">2017 2/26 Sun.</td> </tr> <tr> <td>Department of Mechanical Science and Technology</td> </tr> <tr> <td>Department of Environmental Engineering Science</td> </tr> <tr> <td>Department of Electronics and Informatics</td> </tr> </tbody> </table>		Faculty/School/		Screening date	Faculty of Education		2017 2/25 Sat.	Faculty of Social and Information Studies		2017 2/25 Sat.	Faculty of Medicine	School of Medicine	2017 2/25 Sat. , 2/26 Sun.	School of Health Sciences	2017 2/25 Sat.	School of Science and Technology	Department of Chemistry and Chemical Biology	2017 2/26 Sun.	Department of Mechanical Science and Technology	Department of Environmental Engineering Science	Department of Electronics and Informatics
Faculty/School/		Screening date																				
Faculty of Education		2017 2/25 Sat.																				
Faculty of Social and Information Studies		2017 2/25 Sat.																				
Faculty of Medicine	School of Medicine	2017 2/25 Sat. , 2/26 Sun.																				
	School of Health Sciences	2017 2/25 Sat.																				
School of Science and Technology	Department of Chemistry and Chemical Biology	2017 2/26 Sun.																				
	Department of Mechanical Science and Technology																					
	Department of Environmental Engineering Science																					
	Department of Electronics and Informatics																					
Announcement of successful applicants	2017 3/7 Tue.																					
Other	For questions regarding the Examination for Japanese University Admission for International Students, please contact Japan Student Services Organization. Address 4-5-29 Komaba Meguro-ku Tokyo Japan 153-8503 Phone 81-3-6407-7457																					

Remarks

1. Graduates from the Faculty of Education will be awarded a teachers license. Eligibility to apply for teaching positions varies depending on prefectural and city governments. Please contact the board of education for each prefectural or city government.
2. Graduates from the School of Medicine will be eligible to sit for the national examination for medical practitioners
3. Graduates from the School of Health Sciences will be eligible to sit for national examinations related to their majored subjects
4. For those who applying for the School of Science and Technology, the score for TOEFL-PBT, TOEFL-iBT, TOEFL-ITP, TOEIC public test, TOEIC-IP or IELTS is verified as follows:

Test score subject to verification	Verification method
Score for TOEFL-PBT or TOEFL-iBT (administered in or after January 2015)	Please submit the original and a copy (on A-4 paper) of Examinee Score Report addressed to the applicant. The original will be returned to the applicant together with examination admission ticket.
Score for TOEFL-ITP (administered by Gunma University in or after January 2015)	Please submit the original and a copy (on A-4 paper) of the score card for TOEFL-ITP administered by Gunma University. The original will be returned to the applicant together with examination admission ticket.
Score for TOEFL public test (administered in or after January 2015)	Please submit the original and a copy (on A-4 paper) of Official Score Certificate. The original will be returned to the applicant together with examination admission ticket.
Score for TOEIC-IP (administered by Gunma University in or after January 2015)	Please submit the original and a copy (on A-4 paper) of the Score Report for TOEFL-ITP administered by Gunma University. The original will be returned to the applicant together with examination admission ticket.
Score for IELTS (administered in or after January 2015)	Please submit the original and a copy (on A-4 paper) of Test Report Form addressed to the applicant. The original will be returned to the applicant together with examination admission ticket.
Application Materials	Application and related forms can be downloaded from Admissions page within Gunma University' s website ( <a href="http://www.gunma-u.ac.jp">http://www.gunma-u.ac.jp</a> ). Credit card can be used when applying from overseas.

# GUNMA UNIVERSITY

## How to make a Payment of Examination Fee at Convenience Store or by Credit Card

You can pay the examination fee at a nearby Convenience Store(Lawson, Ministop, FamilyMart, Seven-Eleven, Circle K or Sunkus) by cash, or by a credit card.

### 1 Online Application

Visit the payment website from your computer or cell phone at:

<https://e-shiharai.net/>



※You can not correct or cancel anything once your credit card payment has been made. Please check all your information carefully before you confirm the application.

※If you input the wrong information while trying to obtain your application number, please start again from the beginning and make your payment. If you fail to pay the fee by the due date which you will be noticed after completing the online application, all the information you had input will be canceled automatically.

### 2 Convenience Store Payment

The application fee cannot be paid through an ATM. Be sure to make your payment at the counter.

### Credit Card Payment

[13-digit Payment Slip Number]  
払込票番号

Tell the counter staff that you want to make an "Internet shiharai." Then provide your 【払込票番号】 Payment Slip Number

A multifunction copier can not be used to make payment.

- Make the payment at the register.
- Receive an Application Fee Statement. Detach the Certificate of Payment (receipt) portion.

[11-digit Online Transaction Number]  
オンライン決済番号

Select the "各種支払い" button on the touch screen

"11ケタの番号をお持ちの方" Confirm that you have an 11 digit number

Touch the "オンライン決済番号を入力してお支払い" option Enter your Online Transaction Number to make a payment.

Enter your 【オンライン決済番号】 Online Transaction Number

- Loppi, FamiPort, or K-station issues a funds transfer receipt. You will need to take this to the cash register within 30 minutes and make the actual payment.
- Receive an Application Fee Statement. Detach the Certificate of Payment (receipt) portion.

[11-digit Customer Number]  
お客様番号  
[4-digit Verification Code]  
確認番号

Touch the "各種サービスメニュー" option Various Service Menu

Select the "各種代金・インターネット受け" button on the touch screen All Payments - Internet Reception

Touch the "各種代金お支払い" option All Payments

Touch "マルチペイメントサービス" Multi-Payment Service

Enter your 【お客様番号】 【確認番号】 Customer Number Verification Code

- Payment has been completed. Please write down "受付番号" Receipt Number. Please print out your "取納証明書" Certificate of Payment

You can use a credit card whose holder's name is not yours. However, please make sure that the information on the basic information page is the applicant's information.

Please select "credit card" for the payment method when making your Web application.

Input your card information.

All of your application information is displayed. Check and Click "確定" Confirm.

Payment has been completed. Please write down "受付番号" Receipt Number. Please print out your "取納証明書" Certificate of Payment

### 3 Application

#### Paying at Convenience Store

Attach the receipt portion to "The Certificate of Payment" in the designated location.



Attach Your (Certificate of Payment) to the Application

※When attaching the certificate of payment, be sure to use glue which is suitable for use with thermal paper and pressure-sensitive paper. Please check the glue label.

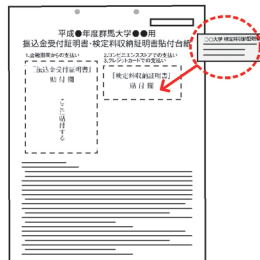

※In the case that you have made your payment using a credit card or at a Convenience Store, you don't need to enclose a bank receipt of any kind.

#### Paying by Credit Card

After making your payment, please make sure you have access to a printer with paper(A4). Access "申込内容照会"(Inquiry) at e-shiharai.net.

Please 「1. Check your card.」 「2. Input Receipt Number.」 「3. Input your Birth Date.(YYYY/MM/DD)」, and click "照会する". Then all of your application information is displayed. Click Blue-button "証明書を発行する". Attach the cutting portion of "取納証明書"(The Certificate of Payment) in the designated location.

Enclose in an envelope with all other necessary application documents.

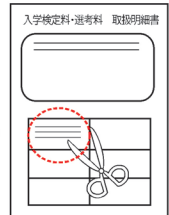

- Please confirm the information on the documents and complete your payment within the application period.
  - If you are paying at a convenience store, please be sure to complete your web application at least 30min before the end of the payment period time.
- In addition, the steps for using information terminals at various convenience stores and payment deadlines for credit card payments are all mentioned in your application guidelines.

- You can print a receipt from the "Application Results" page on the E-shiharai site after making credit card payments only.
- Please contact your credit card company directly if your card is not accepted.

## Information on entrance examination

### ■ Gunma University's website <http://www.gunma-u.ac.jp/>

The following information is available under “Admissions” page:

Application guideline

Information on Open Campus event and other events

Status of and statistics on entrance examination

Tuitions and fees, scholarship

Questions on past entrance examination

How to request for information materials

## Contact information regarding entrance examination

8:30 - 12:00, 13:00 - 17:15 (except Saturdays, Sundays, Holidays, year-end and New Year holidays)

**Applicants should personally contact the University as our university looks for students who actively participate in learning.**

### ■ Inquiries regarding this brochure and general inquiries about admission

Admissions Office

Phone 81-27-220-7150, 7151 or 7152 Fax 81-27-220-7155

Address: 4-2 Aramaki-machi Maebashi Gunma Japan 371-8510

### ■ Inquiries regarding questions specific to each Faculty/School

Faculty of Education (Registrar)

Phone 81-27-220-7223

Address: 4-2 Aramaki-machi Maebashi Gunma Japan 371-8510

Faculty of Social and Information Studies (Registrar)

Phone 81-27-220-7404

Address: 4-2 Aramaki-machi Maebashi Gunma Japan 371-8510

Faculty of Medicine

Phone 81-27-220-8910 (School of Medicine)

Phone 81-27-220-8909 (School of Health Sciences)

Address: 3-39-22 Showa-machi Maebashi Gunma Japan 371-8511

School of Science and Technology

Phone 81-277-30-1037

Address: 1-5-1 Tenjin-cho Kiryu Gunma Japan 376-8515

Admission information provided in real time via LINE and Twitter



[http://lineat.jp/gunma\\_uni\\_ad](http://lineat.jp/gunma_uni_ad)



[http://twitter.com/gunma\\_uni\\_ad](http://twitter.com/gunma_uni_ad)